

# Long Island Tax Map

Sheet 6: Old Cove

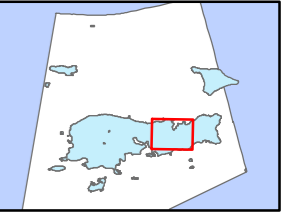

Unlabeled parcels			
Lot No.	Name	Lot No.	Name
447	Rich, Catherine Heirs	643	Johnson, Claire E. Heirs
449	Parker, George R. II	652	Marcisso, Karen E. and Samuel
460	Unknown Ownership	655	Miller, Joseph T.
522	Hanson, Steven M.	669	Collins, Susan H.
524	Berges, Nancy M.	671	Wilcox, Fulton R.
528	L.I. Com. Land Op. Co. LLC	675	Bery, William Clark Jr.
603	Clarke, Coleman R.	677	Libby, Margaret F.
624	Gore, Daniel	685	Unknown Ownership
634	Stewart, Craig A.	709	Johnson, Thomas G.
635	Lovely, Richard C.	716	Woods, Derelisa EIAI
640	Mooney, Deborah J.	719	Horr, Malcolm E. Family Trust
720	Horr, Malcolm E. Family Trust	723	DeAngelis, Barbara A.
731	MacVane, Donald A. EIAI	732	MacVane, Thomas S.
733	MacVane, Charlotte S.	734	Miles, Francis H.
735	Miles, Francis H.	736	East West Paradise, LLC
737	East West Paradise, LLC	738	Flower, JoAnn L. Trustee
739	Souter, John C. Trustee	740	ocean ave, paper street
759	Ciard, Richard I.	767	Jordan, Nancy H. Revocable Lvg
769	doCanto, Jennifer R.	781	Brayley, Constance E.
801	Murphy, Martha Jane	801	Murphy, Martha Jane
834	Horr, Robert	841	Thomas, Maureen S.
842	Town of Long Island	842	Town of Long Island

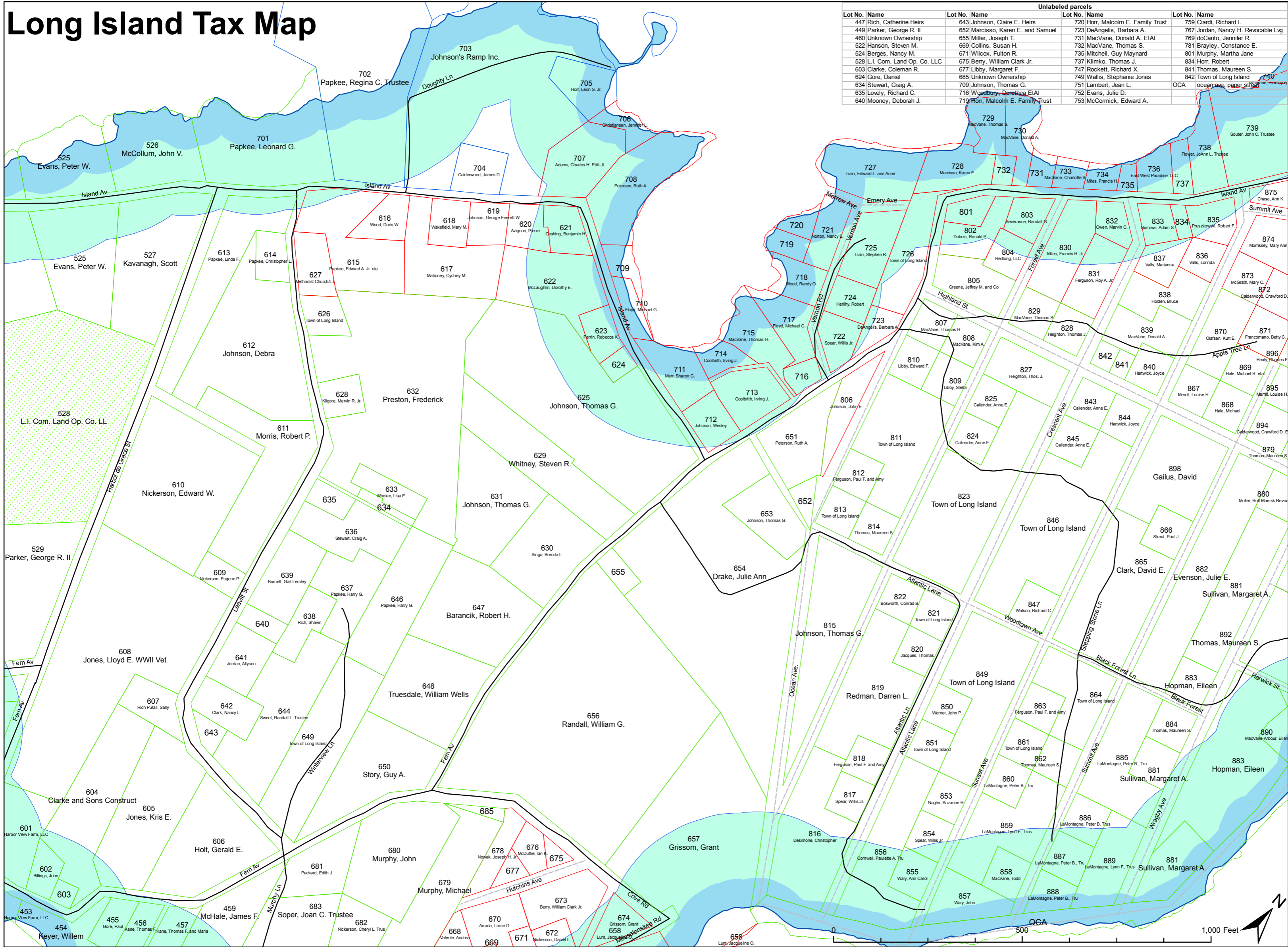

## Zones

- IB: Business
- IR1: Residential
- IR2: Residential
- R-OS: Open Space
- RPZ: Resource Protection

## Shoreland Zone

- 75 foot setback
- 250 foot setback

## Roads

- Approved E-911 streets
- Proposed "paper" streets

Town of Long Island  
PO Box 263,  
Long Island, ME 04050

(207) 766-5820

[www.townoflongisland.us](http://www.townoflongisland.us)

For planning and assessing purposes only. Only a registry-certified deed and survey can accurately determine boundaries.

Streets shown may not be legal access.

Only approved E-911 street names are valid legal addresses

Parcels are identified by lot number and first owner listed in tax database; consult tax records for complete ownership information.

This map contains data from the Maine Office of GIS:  
<http://megis.maine.gov/>

NAD 83 / UTM Zone 19N

1:2400 scale: one half inch equals 100 ft

Rev. 9-9-2010



1,000 Feet

