

# Long Island Tax Map

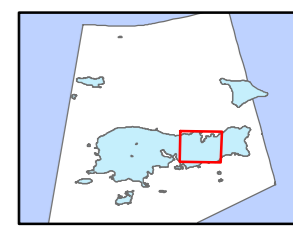

Lot No.	Name	Lot No.	Name	Lot No.	Name	Lot No.	Name
447	Rich, Catherine Heirs	643	Johnson, Claire E. Heirs	720	Horr, Malcolm E. Family Trust	759	Clardi, Richard I.
449	Parker, George R. II	652	Marcisso, Karen E. and Samuel	723	DeAngelis, Barbara A.	767	Jordan, Nancy H. Revocable Lvg
460	Unknown Ownership	655	Miller, Joseph T.	731	MacVane, Donald A. E/Al	769	doCarro, Jennifer R.
522	Hanson, Steven M.	669	Collins, Susan H.	732	MacVane, Thomas S.	781	Brayley, Constance E.
524	Berges, Nancy M.	671	Wilcox, Fulton R.	735	Mitchell, Guy Maynard	801	Murphy, Martha Jane
528	L.I. Com. Land Op. Co. LLC	675	Berry, William Clark Jr.	737	Klimko, Thomas J.	834	Horr, Robert
603	Clarke, Coleman R.	677	Libby, Margaret F.	747	Rockett, Richard X	841	Thomas, Maureen S.
624	Gore, Daniel	685	Unknown Ownership	749	Wallis, Stephanie Jones	842	Town of Long Island
634	Stewart, Craig A.	709	Johnson, Thomas G.	751	Lambert, Jean L.		
635	Lovely, Richard C.	716	Woodbury, Dorthea E/Al	752	Evans, Julie D.		
640	Mooney, Deborah J.	719	Horr, Malcolm E. Family Trust	753	McCormick, Edward A.		

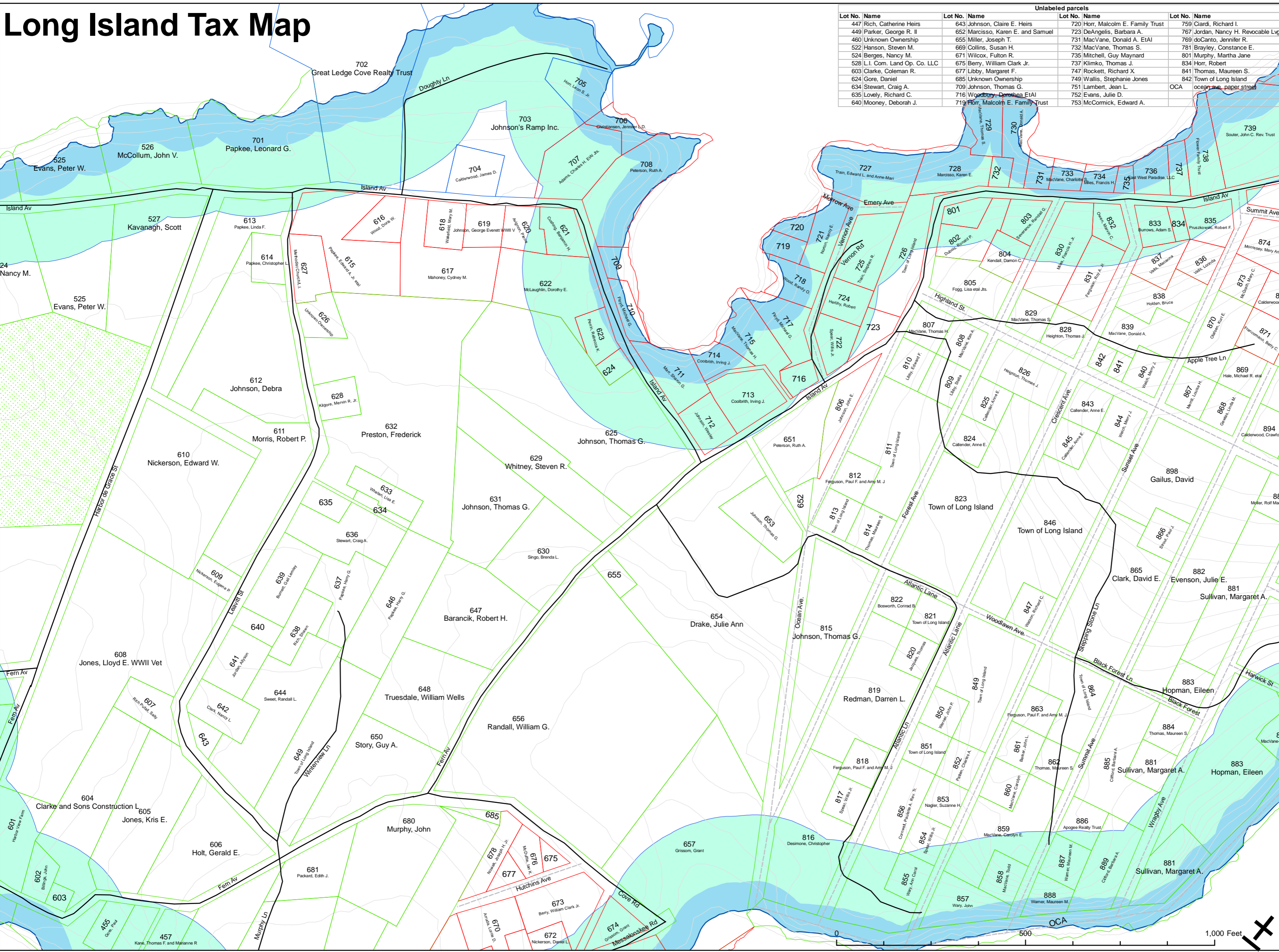

- Zones**
- IB: Business
  - IR1: Residential
  - IR2: Residential
  - R-OS: Open Space
  - RPZ: Resource Protection

- Shoreland Zone**
- 75 foot setback
  - 250 foot setback

- Roads**
- Approved E-911 streets
  - Proposed "paper" streets

Town of Long Island  
 PO Box 263,  
 Long Island, ME 04050  
 (207) 766-5820  
[www.townoflongisland.us](http://www.townoflongisland.us)

For planning and assessing purposes only. Only a registry-certified deed and survey can accurately determine boundaries.

Streets shown may not be legal access.

Only approved E-911 street names are valid legal addresses

Parcels are identified by lot number and first owner listed in tax database; consult tax records for complete ownership information.

This map contains data from the Maine Office of GIS:  
<http://megis.maine.gov/>

NAD 83 / UTM Zone 19N  
 1:2400 scale: one half inch equals 100 ft

Rev. 6, 2-20-08

